

All patches terminate at Patch Bay in Prompt Side Gallery

186 & 187 are single power points w/switches

DMX = DMX inlet (5 pin Cannon Male, pins 4-5 N/C)

Venue	Description
Altona Theatre	LX Patch Map
Scale	Level
Not To Scale	Stage / Pit

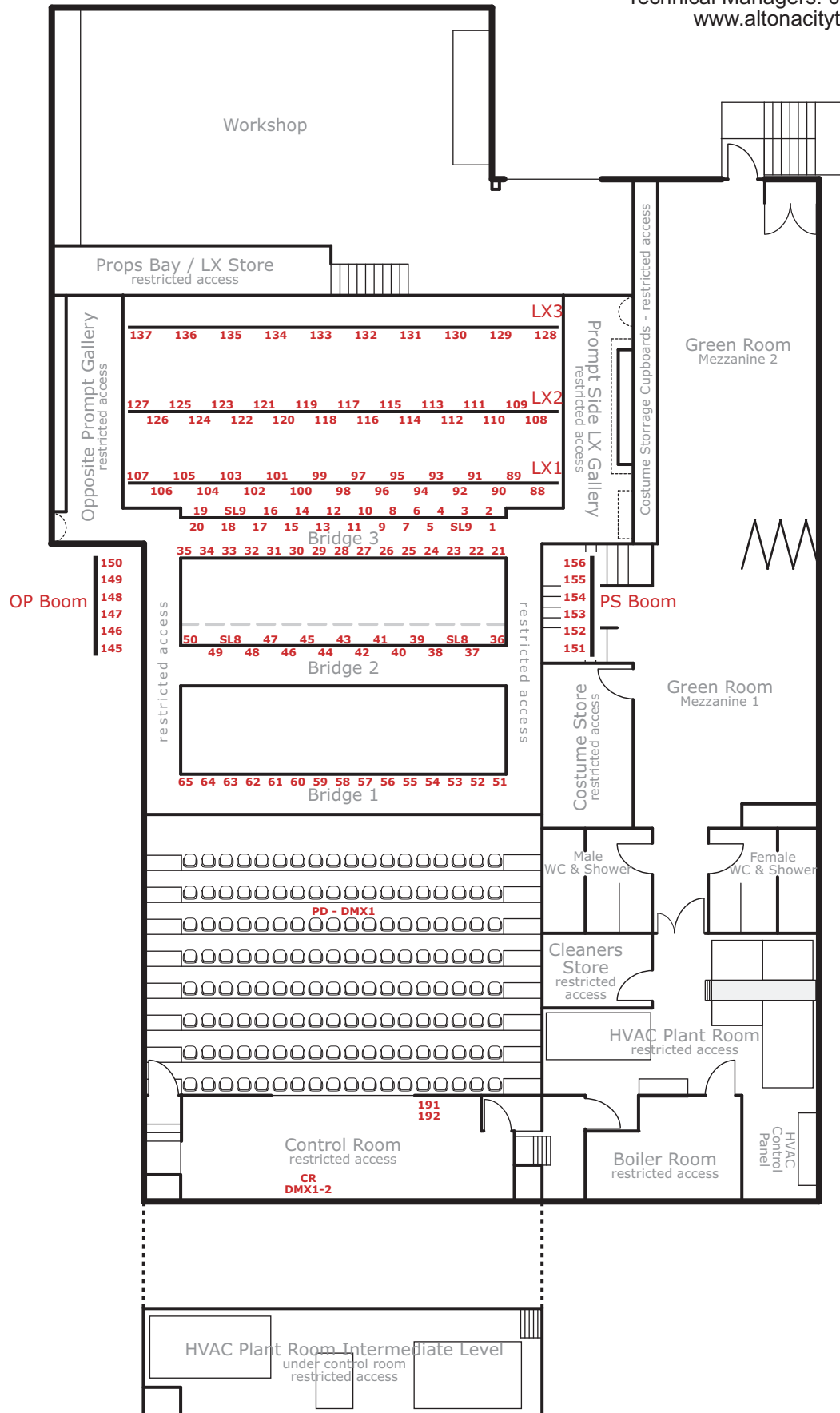

All patches terminate at Patch Bay in Prompt Side Gallery

SL8/9 = White working light circuits, hardwired to SM console

191 & 192 are single power points w/switches

DMX = DMX inlet (5 pin Cannon Male, pins 4-5 N/C)

Venue	Description
Altona Theatre	LX Patch Map
Scale	Level
Not To Scale	Grid / Mezzanine