

All patches, except RELAY, terminate in Control Room beside audio desk (Prompt Side end)

M, RELAY = Microphone Patch (Cannon Female)
LR = Line Return (Cannon Male)
AF = Amplifier Feed (Cannon Female)

PS M9-16 have both gender connectors at each end, can be used for gender swapping
TRAP TIE is a tie line from the trapdoor to Prompt Side patch

Venue	Description
Altona Theatre	Audio Patch Map
Scale	Level
Not To Scale	Stage / Pit

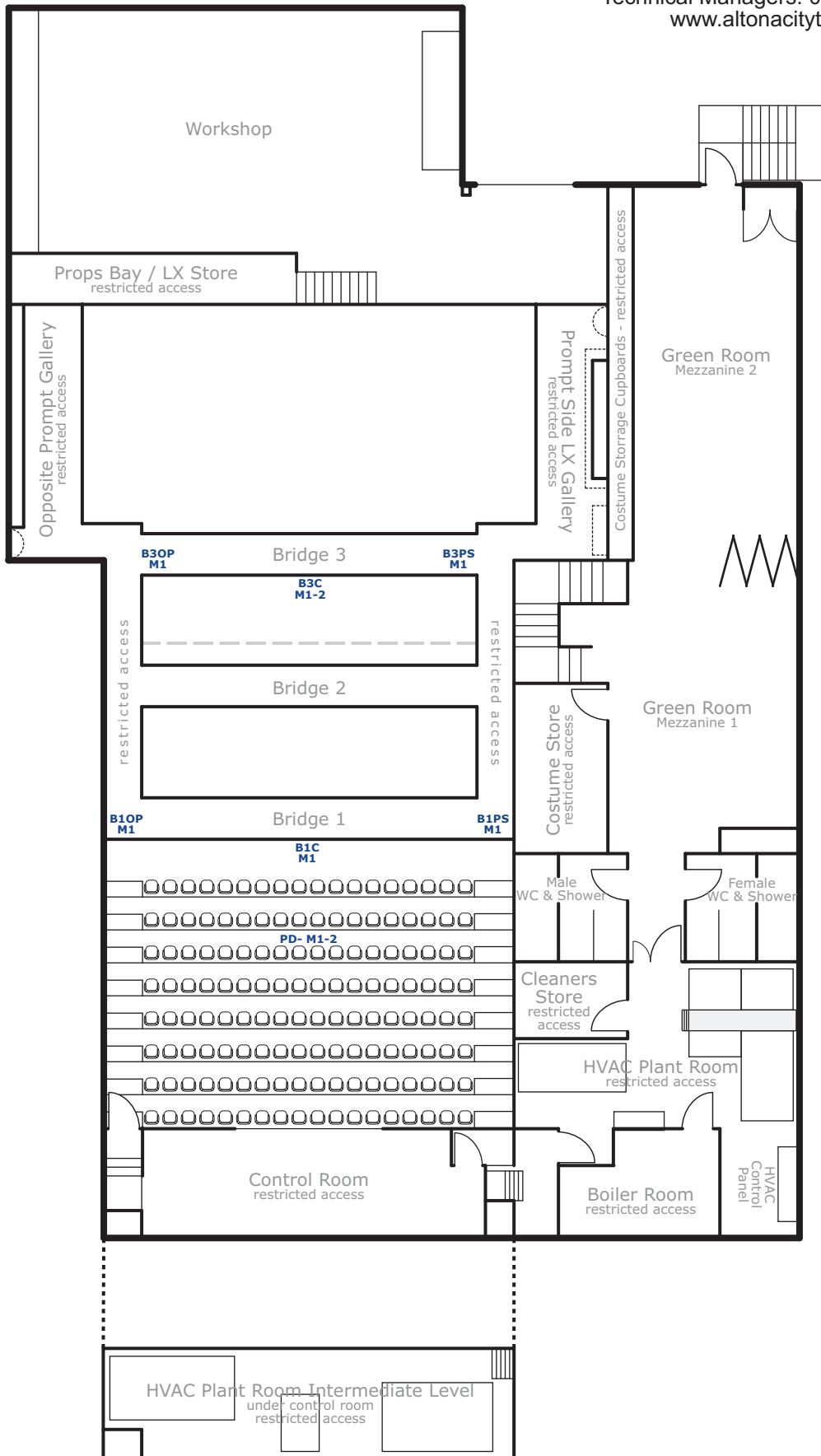

Venue	Description
Altona Theatre	Audio Patch Map
Scale	Level
Not To Scale	Grid / Mezzanine

All patches terminate in Control Room beside audio desk (Prompt Side end)

M = Microphone Patch (Cannon Female)